

American Lutheran Church

Parking

Patients: Please stop at Admissions FIRST unless you have an appointment with a specialist located in the Central Tower.

4th Street

4th Street

Iowa Avenue

Alley

Central Tower

1st Floor

Main Entrance

Rehabilitation Services

Admissions

Respiratory Therapy

Laboratory

Legacy Plaza

Same Day Surgery

Surgery

Medical Imaging (X-Ray)

Emergency Room



5th Street

5th Street

Parking

HRMC Physicians Clinic

Parking

Professional Arts Building

HRMC Campus Map

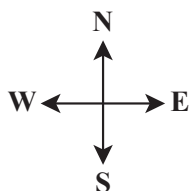

- Public Elevator
- Public Stairs
- Public Restroom
- Public Telephone
- Vending

2nd Floor

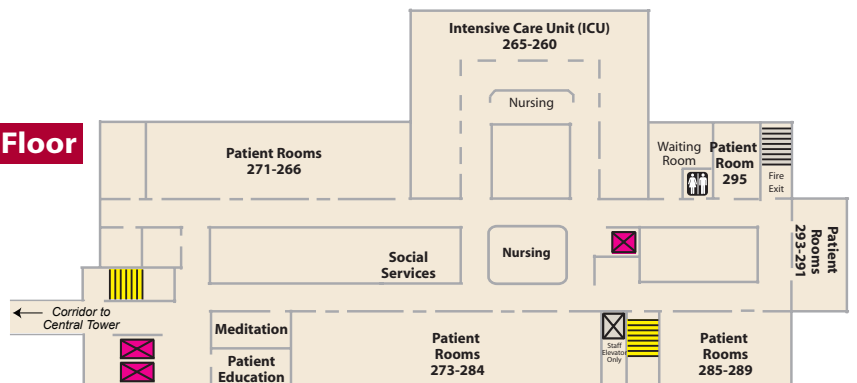

3rd Floor

